

Y-STRAINER

TYPE 6550



GENERELT

DIMENSIONS:	DN15 - DN200
PRESSURE:	PN16
MATERIAL:	CAST IRON EN-GJL-250
INSERT:	STAINLESS STEEL AISI 304
MAX TEMPERATURE:	300°C
MESH:	DN15-DN50 = 1.00 MM DN64-DN80 = 1.25 MM DN100 - DN200 = 1.60 MM
CONNECTION:	FLANGE EN1092-2

OPTIONS

DIMENSIONS:	DN250 - DN400
-------------	---------------

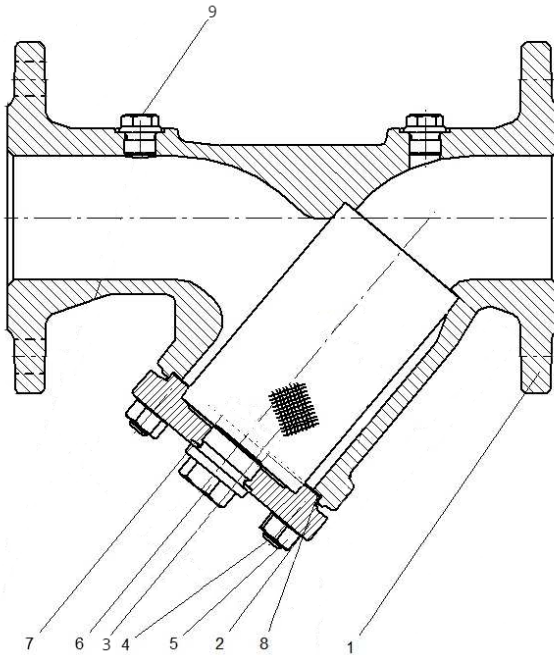

POS	DESCRIPTION	MATERIAL
1	BODY	CAST IRON EN-GJL-250
2	COVER	CAST IRON EN-GJL-250
3	INSERT	STAINLESS STEEL AISI 304
4	STUDS	STEEL 5.6-A3A
5	HEXAGON NUT	STEEL 5-A3A
6	EMPTYING SCREW	STEEL C35E
7	PLUG GASKET	STAINLESS STEEL AISI 316
8	COVER GASKET	GRAPHITE + CrNiSt
9	1/4" CONNECTION	STEEL C35E

DESCRIPTION

- **Y-strainer in cast iron with stainless steel insert.**
- **Use for mechanical cleaning of various media** in piping before control valves, pumps, steam traps.
- **Can be mounted in any position** with the flow in the direction of the arrow.
- **Installation of filter pollution indicator possible.**

DIMENSIONS

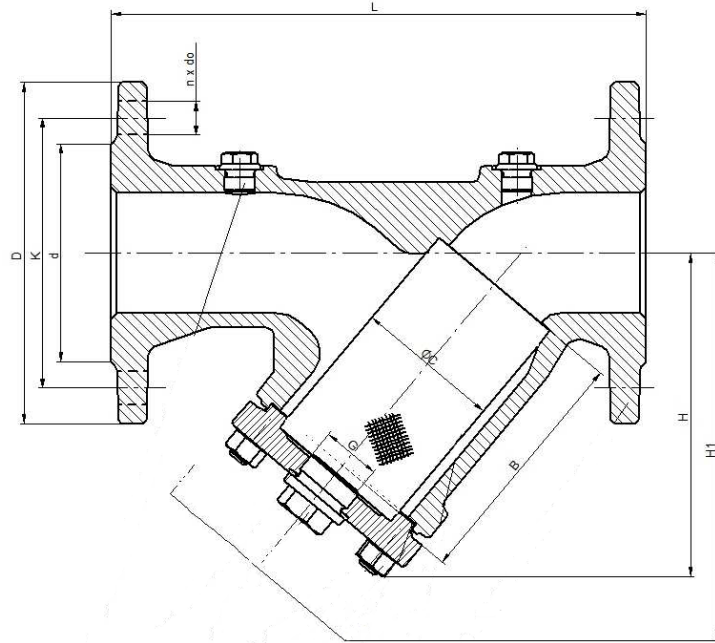

DIM	L [MM]	H [MM]	H1 [MM]	C [MM]	B [MM]	G [INCH]	WEIGHT [KG]
15	130	90	135	23,0	56	3/8	2.6
20	150	100	160	28,0	68	3/8	3.0
25	160	115	180	36,0	85	3/4	4.3
32	180	135	215	42,0	98	3/4	6.8
40	200	150	240	50,0	114	1	9.0
50	230	160	250	61,5	119	1	11.0
65	290	180	285	78,5	134	1	14.6
80	310	215	330	89,5	149	1	18.6
100	350	240	395	109,5	169	1 1/2	27.0
125	400	280	455	137,5	199	1 1/2	38.5
150	480	330	525	160,0	224	1 1/2	54.5
200	600	405	650	210,0	284	1 1/2	110.0
250	730	540	870	258,0	434	1 1/2	165.0
300	850	680	1110	308,0	555	1 1/2	285.0
350	980	755	1250	365,0	640	1 1/2	373.0
400	1100	835	1370	415,0	695	1 1/2	540.0

Q/dp-DIAGRAM

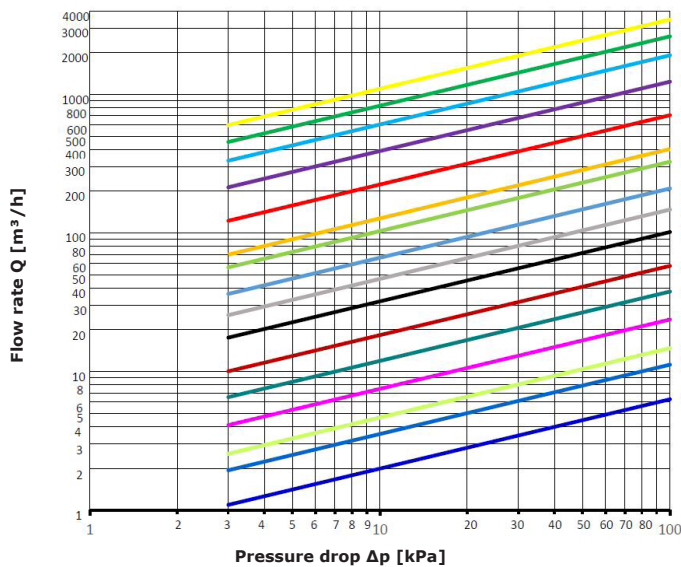

PRESSURE/TEMPERATURE

