

## Product information

High-pressure steel stop valve, PN160. Used as a shut-off valve for process water, aggressive media, among others. Suitable for industrial applications.

|                      |           |
|----------------------|-----------|
| Dimension range (DN) | 15 - 50   |
| PN                   | 63 - 160  |
| Temperature (°C)     | -10 - 450 |
| Main material        | Steel     |

---

## Area of use

For applications in industrial installations, hospitals, food and beverages, processing technology, vapour facilities, plant manufacturing. As a shut-off valve for process water, aggressive media, among others.

Flanged connections: 1060A\_F

Butt valve welded connections: 1060A\_S

## Tender text

**PSB.5 Ball valves and needle valves**

## Quality assurance

PED 2014/68/EU

**The product is CE marked**

**Product marking:** Manufacturer, DN, PN, CE, Material and flow direction

## Energy and environment declaration

**Reach date:** 12/3/2024 1:00:04 PM

**Reach note:** The product is not covered by REACH

### List of details

| Pos | Component | Material                             |
|-----|-----------|--------------------------------------|
| 1   | Body      | Steel P250GH (1.0460)                |
| 2   | Bonnet    | Steel P250GH (1.0460)                |
| 3   | Seat      | Steel P250GH (1.0460)                |
| 4   | Globe     | Martensitic stainless steel (1.4021) |
| 5   | Spindle   | Martensitic stainless steel (1.4021) |

Stellite-reinforced sealing between seat and globe.

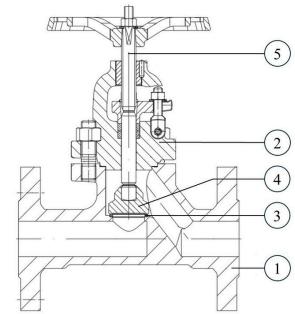

### Measurements and weight

**Dimension range (DN):** 15 - 50

| Item number | A   | B   | C   | D   | Net weight (kg) |
|-------------|-----|-----|-----|-----|-----------------|
| 1060A15F    | 210 | 228 | 180 | 105 | 8.9             |
| 1060A20F    | 230 | 228 | 180 | 130 | 10.5            |
| 1060A25F    | 230 | 228 | 180 | 140 | 11.5            |
| 1060A25S    | 160 | 228 | 180 |     | 6.6             |
| 1060A40F    | 260 | 292 | 225 | 170 | 21              |
| 1060A50F    | 300 | 300 | 225 | 195 | 27              |

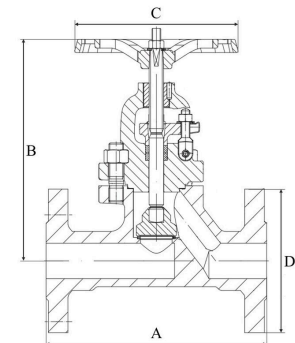

### Function and design

With rising, externally threaded stem. Metal-sealing with a seat reinforced with Stellite.

Max operational pressure and temperature:

- 160bar at 120°C
- 145bar at 150°C
- 130bar at 200°C
- 112bar at 250°C
- 96bar at 300°C
- 90bar at 350°C
- 80bar at 400°C
- 60bar at 450°C

## Technical data

**Main material:** Steel

**Main material code:** Steel P250GH (1.0460)

**Included materials:** Steel, Stainless steel

**Included material code:** Martensitic stainless steel (1.4021), Steel P250GH (1.0460)

**Temperature (°C):** -10 - 450

**PN:** 63 - 160

**Connection:** Flanged EN1092, EN 12627, butt weld ends

**ETIM classification:** EC010120 - Globe valve

| DN  | 15  | 20  | 25  | 40   | 50 |
|-----|-----|-----|-----|------|----|
| KVS | 4.2 | 6.4 | 8.6 | 24.2 | 33 |

## Installation and maintenance

**Flowdirection:** Uni-directional

**Possible mounting position:** Vertical, Horizontal

Can be installed with the stem in any direction, but not with downward-facing handwheel. The preferred stem position is vertical. The system should be flushed before commissioning. The valve should be closed during welding.

Please feel free to contact us

We answer your questions by e-mail and telephone. No question is too small, no challenge is too big. You are always welcome at Armatec.

[info@armatec.se](mailto:info@armatec.se) | +46 31 89 01 00 | [www.armatec.se](http://www.armatec.se)

THE COMPANY'S MANAGEMENT SYSTEM  
IS CERTIFIED BY DNV  
ISO 9001 • ISO 14001