

FOR USE IN EUROPE

CATALOG No.
 MANUFACTURING No.

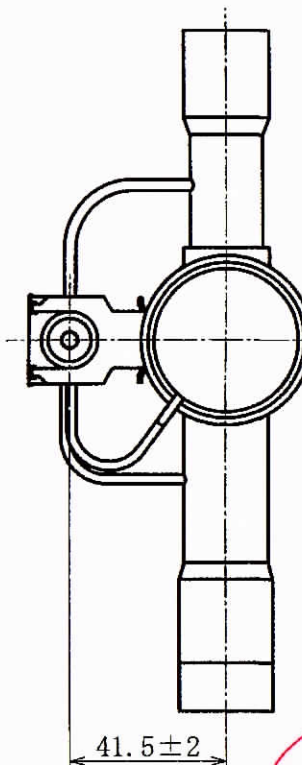

EXAMPLE
 6 02 6
 YEAR
 DAY
 MONTH 1~9: JAN. ~SEP.
 X: OCTOBER
 Y: NOVEMBER
 Z: DECEMBER

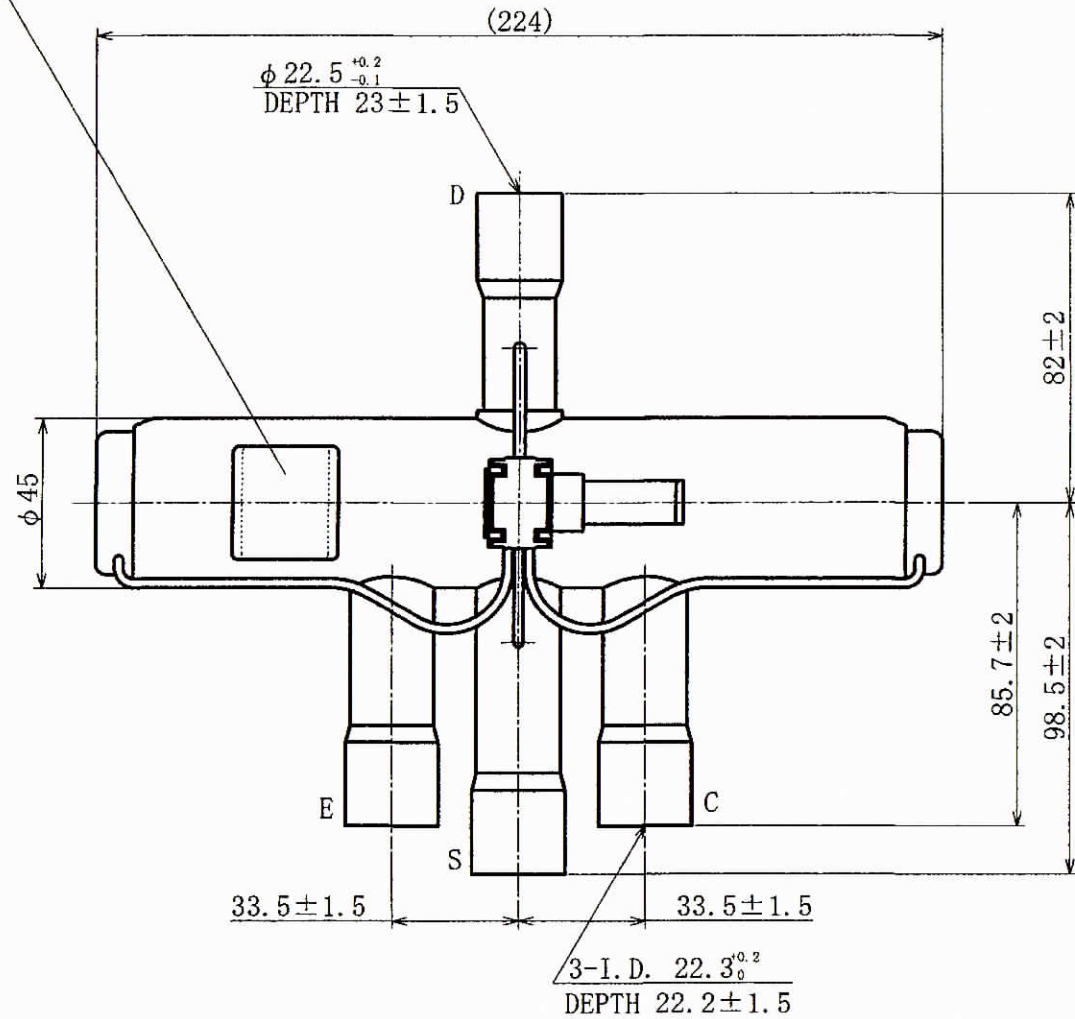

RELEASED DRAWING
 DATE JUL 11, 2016.
 Quality Management DEPT.
 SAGINOMIYA SEISAKUSHO, INC.

SPECIFICATIONS

WATER TEST PRESSURE	WITH WATER PRESSURE 6.44 MPa { 64.4 bar}
AIRTIGHT TEST PRESSURE	WITH AIR PRESSURE 4.5 MPa { 45.0 bar}
MAX. WORKING PRESSURE	4.5 MPa { 45.0 bar}
CONNECTION	ILLUSTRATE
FLUID	R22, R407C, R410A
PORT SIZE	20 mm
VALVE OPERATION	PILOT OPERATED 4-WAY REVERSING VALVE
DURABILITY	40,000 (R22, R407C) OR 20,000 (R410A) TIMES TESTED BY AIR PRESSURE UNDER DISCHARGE PRESSURE 1.47 MPa {14.7bar} (R22, R407C) OR 2.5 MPa (25bar) (R410A), SUCTION TUBE OPEN TO ATMOSPHERE AND BODY TEMP. NORMAL TEMPERATURE (LUB. OIL APPLIED DURING THE TEST)
MAX. OPERATING PRESS. DIFFERENTIAL	3.1 MPa { 31 bar}
MIN. OPERATING PRESS. DIFFERENTIAL	0.3 MPa { 3 bar}
VALVE LEAKAGE	6000 cm ³ /min. OR LESS WITH AIR UNDER O. P. D. 1 MPa { 10bar} AND BODY TEMP. NORMAL TEMPERATURE BUT 9000 cm ³ /min. OR LESS AFTER THE DURABILITY TEST.
CAPACITY	R22, R407C : 18 ~ 45 kW *1 R410A : 21 ~ 53 kW
MIN. OPERATING VOLTAGE	*2 85% OR LESS OF RATED VOLTAGE AT ΔP 2.5MPa (25bar)
AMBIENT TEMPERATURE	-20 ~ +55 °C
ALLOWABLE FLUID TEMPERATURE	-20 ~ +120 °C
MAX. ALLOWABLE TEMPERATURE	+120 °C

MOUNTING POSITION

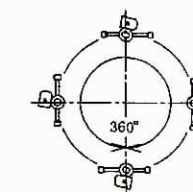

AVAILABLE TO INSTALL IN ANY POSITIONS WITH THE BODY AXIS HOLD HORIZONTALLY. 360°

AVAILABLE TO INSTALL IN ANY POSITIONS WITH THE BODY AXIS VERTICALLY AND THE SOLENOID COIL LOCATED ABOVE THE CENTER OF THE VALVE. 360°

CONNECTIONS INDICATED BELOW SHOW AT COOLING MODE (WHEN COIL IS DE-ENERGIZED)

- D CONNECTION : DISCHARGE
- C CONNECTION : CONDENSER
- S CONNECTION : SUCTION
- E CONNECTION : EVAPORATOR

WE MANUFACTURE THE PRODUCT BASED ON THE SPECIFICATIONS DESCRIBED IN THIS DRAWING. PLEASE CHECK THE SAFETY AND VALIDITY IN THE PRODUCT DESIGN IN CONSIDERATION THAT THE PRODUCT IS CONFORMED TO THE SYSTEM OR NOT WHEN USING.

- *1 BE SURE TO CHANGE OVER 4-WAY VALVE WITHIN THE RANGE OF CAPACITY DESCRIBED IN THE DRAWING. DISCHARGE PRESSURE RISE OR STOP OF THE INTERNAL VALVE AT AN INTERMEDIATE POSITION MAY OCCUR IF IT IS CHANGED OVER OUTSIDE THE CAPACITY RANGE.
- *2 WHEN THERE IS A DIFFERENCE IN THE MIN. OPERATING VOLTAGE AND THE ALLOWABLE VOLTAGE VARIATION IN THE COIL DRAWING, A COIL DRAWING IS GIVEN PRIORITY TO.

Approved by A. Imoto	Date JUN. 02. 2006	Name 4-WAY REVERSING VALVE BODY	
Designed by R. Mitome	Scale 1:2	Catalog Number STF-0728G3	Drawing Number N-HV-17101-B
Drawn by R. Mitome	SAGINOMIYA SEISAKUSHO, INC.		

B JUL. 2. 2016 REVISED(CHANGE LABEL etc.) MITOME
 A MAY. 14. 2007 RENEWAL(REVISION OF FLUID, DURABILITY CAPACITY etc.) KUMADA