

 PRESTERA™

## Product information

High quality valve made of ductile iron with duplex stainless steel disc and has a vulcanised lining for a long product life cycle. The EPDM rubber used in the valve is suitable for hot water, salt water, ammonia water, air, neutral gases, some diluted inorganic acids and some alcohols (max 30%). The connection is flanged according to EN1092. The valve has low torque and low pressure drop. Choose Butterfly Valve AT 2313B for reliable and efficient operation.

Dimension range (DN)	40 - 600
PN	16
Temperature (°C)	-20 - 110
Main material	Ductile iron

## Area of use

This product is of the highest quality and is designed to withstand pressure class PN16 and temperatures ranging from -20 to 110 °C. It is developed to fit within the dimensional range (DN, liters) from 40 to 600. With this product, you can be sure that you are getting a reliable and robust solution for your needs.

For shut-off and regulation of:

- Hot and cold water:
- Heating and cooling systems
- Water-glycol mixtures
- Water with some oil content
- Saltwater, brackish water
- Vacuum
- Neutral gases

EPDM rubber: Hot water, air, neutral gases, some diluted inorganic acids, some alcohols (max 30%).

## Tender text

### **PSB.2 Rotary butterfly valves**

Butterfly valve AT 2313B, with a cast iron body and a fixed vulcanized EPDM liner in the body, as well as a duplex stainless steel disc.

AT 2313BS with lever standard up to DN150,

AT 2313BV with gearbox standard from DN150.

## Quality assurance

PED 2014/68/EU, AFS 2016:1

### **The product is CE marked**

**Product marking:** Model, DN, Flange, Bodymaterial, Seat material, Disc material, PS, TS, PT, date of test, serialnumber, standard and AT-number

## Energy and environment declaration

### **Reach notification obligation**

**Reach date:** 6/14/2023 12:00:00 AM

Pos	Component	Material
-----	-----------	----------

Measurements and weight

Dimension range (DN): 40 - 600

Item number	A	B	C	D	E	F	Net weight (kg)
33	86	58	12	34			3
33	86	58	12				3.1
43	100	63	12	34			4
43	100	63	12				4.1
46	115	71	12	34			5
46	115	71	12				5.1
46	130	78	12	34			5
46	130	78	12				5.1
52	150	98	12	34			6
52	150	98	12	12			6.1
56	182	109	12	34			9
56	182	109	12	16			9.1
56	210	133	14	34			10
56	210	133	14				10.2
60	262	158	14				15.2
68	315	194	15				24.85
78	371	219	15				36.85
78					24		43
102	363	305			28	27	73

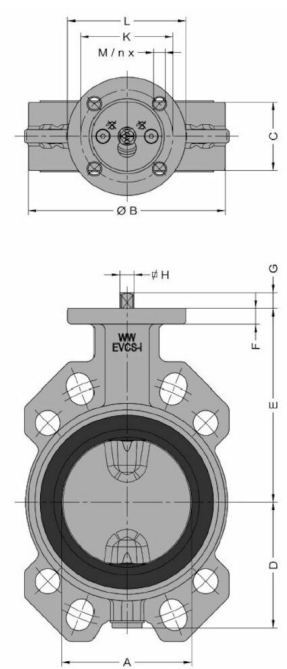

Item number	A	B	C	D	E	F	Net weight (kg)
114	388	330			28	27	86
127	460	373			37	36	125
154	510	423			37	36	170
33	86	58	12				2
43	100	63	12				3
46	115	71	12				4
46	130	78	12				4
52	150	98	12				5
56	182	109	12				8
56	210	133	14				9
60	262	158	14				14
68	315	194	15				23
78	371	219	15				35

DN	X	Y
40	24	4
50	27	4
65	47	10
80	67	18
100	87	25
125	113	35
150	140	48
200	191	70
250	242	92
300	289	111

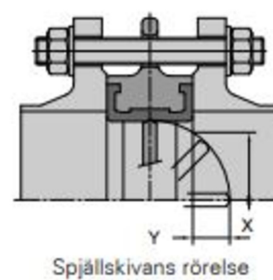

## Function and design

Fully sealed maintenance-free butterfly valve with a centrally located disc, split spindle, and a completely housed body with in-house vulcanized rubber lining that eliminates the risk of gap corrosion, protects the valve body internally against corrosion, and serves as a flange gasket. The manufacturing process ensures excellent sealing and increased lifespan as wear of the lining is eliminated. The profile of the disc is crucial to achieving good flow characteristics, which ultimately leads to minimizing energy losses. The valve is tight regardless of the flow direction.

Valve body with semi-LUG mounting ears for one-sided installation. AT 2313B is equipped with mounting ears up to DN 350. Hole pattern DN40-DN350 fits flanges PN6/PN10/PN16 and CL150. Construction length according to SS-EN 558, series 20. Top flange according to ISO 5211.

Standard surface treatment class C3 according to ISO 12944.

For outdoor installation where there are significant amounts of air pollution or moderate amounts of salt, such as in industrial and coastal areas, without rain protection, class C4 is recommended.

## Technical data

**Main material:** Ductile iron

**Main material code:** Ductile iron GJS-400-15 (GGG40)

**Included materials:** Ductile iron

**Included material code:** Ductile iron GJS-400-15 (GGG40)

**Temperature (°C):** -20 - 110

**PN:** 16

**Connection:** Flanged EN1092

**ETIM classification:** EC010910 - Butterfly valve

**BK04 code:** 20706 Single-leaf dampers

**Product colour:** RAL 2000 - Yellow orange

## Installation and maintenance

**Flowdirection:** Bi-directional

**Possible mounting position:** Vertical, Horizontal

**Possible mounting position notes:** The stem should not be mounted so that it is pointing downwards as this may cause leakage.

The valve is intended to be mounted between flanges, without gaskets, and where possible with the shafts in a horizontal position, avoid mounting the valve with the shaft downwards. In case of unilateral mounting, bolts and nuts shall not be tightened with a higher torque than specified in the table of the relevant standard. The valve should be exercised regularly to avoid the accumulation of dirt that can lead to leakage.

Please feel free to contact us

We answer your questions by e-mail and telephone. No question is too small, no challenge is too big. You are always welcome at Armatec.

[info@armatec.se](mailto:info@armatec.se) | +46 31 89 01 00 | [www.armatec.se](http://www.armatec.se)

THE COMPANY'S MANAGEMENT SYSTEM  
IS CERTIFIED BY DNV  
ISO 9001 • ISO 14001