

ESEGUIRE BICCHIERINI DOPO MANDRINATURA

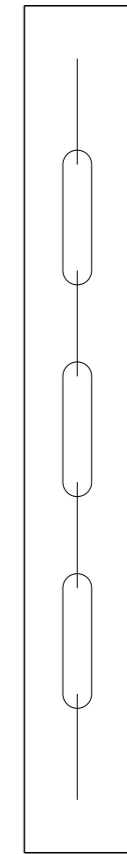

LATO CURVETTE

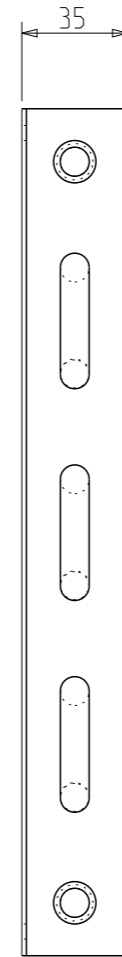
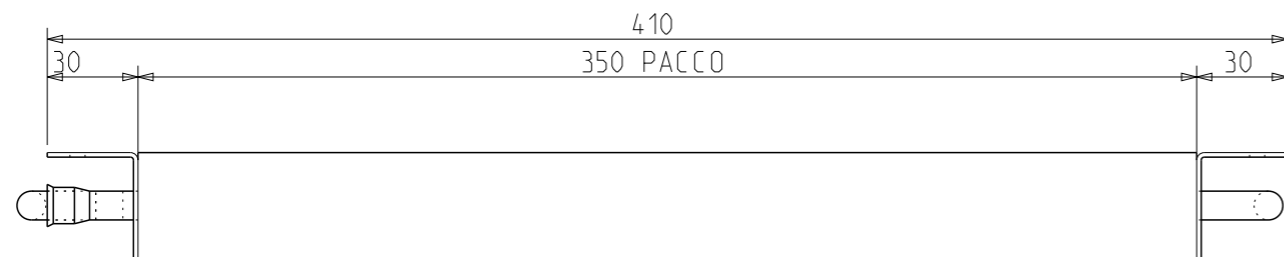

- ALETTE MN020222
- TUBI MN010104
- FIANCATE IN ALLUMINIO MAGNESIO 15/10
- VERNICIATURA TOTALE COLOR GRIGIO RAL7001 MN060014
- PS. 60 bar
- BATTERIA PER Co2

IND.	MODIFICHE	DISEGNATO	DATA
<p>This drawing is property of Modine and embodies a confidential property design. It may not be reproduced, disclosed ore copied, in whole or in part, without prior written authorization. Tolleranze generali secondo SP012 / General tolerances according to SP012</p>			
		Sigla : I035A080I035080E010I Rif. Cliente : 24081359 CO2 EVAP	File : B05995 Dis. : B05995
		Disegnato: NICOLETTI	Data: 24/10/2018