

OPERATING PRESSURE CHANGES ACCORDING TO CHANGE OF AMBIENT TEMP ON WATER PROOF TYPE

AMBIENT TEMP	-20°C	70°C	100°C
CHANGE OF CHARACTERISTICS	-0.2 bar	+0.25 bar	+0.4 bar

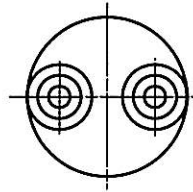

HEAT PROOF ELECTRIC VINYL WIRE  
UL1015, AWG18, 105°C (BLACK)

2 LABEL

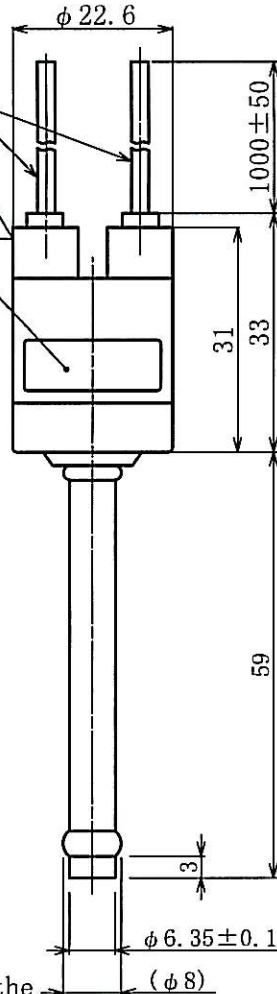

AT BRAZING OF PIPES, WRAP THE SWITCH BODY WITH WET CLOTH AND KEEP THE TEMPERATURE OF SWITCH BODY UNDER 100°C

OPERATING PRESS. CHARACTERISTICS:	OPERATING PRESS. SETTING		DIFFERENTIAL			
	UNIT: bar					
	OFF	O N				
	0 ± 0.3	0.7 ± 0.4	—			
ELECTRICAL RATINGS	RATED VOLTAGE (V)		PF	A C	DC	
	RATED AMPS. (A)		Cos φ	125	250	12
	NON-INDUCTIVE AMPS.		1	1~6	1~4	1~4
	INDUCTIVE AMPS.	FULL LOAD AMPS.	0.75	1~6	1~4	—
STARTING AMPS.		0.45	1~2	1~16	—	
TYPE OF CONTACT						
CONTACT RESISTANCE	LESS THAN 200 mΩ					
INSULATION RESISTANCE	NOT LESS THAN 100 MΩ AT DC 500V MEGGER					
DIELECTRIC STRENGTH	WITHSTAND 1500V AC FOR ONE MINUTE					
MAX. PRESSURE	35 bar					
AIR TIGHT PRESS.	35 bar					
TEST PRESS.	40 bar					
MAX. ALLOW. TEMP.	-30 ~ 100 °C (But no freeze)					
DURABILITY	10,000 TIMES					

1-4-5  
1-2020

1

★CONFIRMATION OF DESIGN VALIDITY

We manufacture the product based on the specifications described in this drawing. Please check the safety and validity in the product design in consideration that the product is conformed to the system or not when using.

NOV. 10. '03	2	INK STAMPING -> LABEL
13. NOV. '01	1	REV. SHAPES, ADD. NOTE & ADD. CONFIRMATION OF DESIGN VALIDITY
DATE	SIGN	CHANGE CONTENT

Checked by	Date	NAME	TYPE CB PRESSURE SWITCH
T. T.	01. JUL. 1999		
Designed by	Scale	Catalog Number	Drawing Number
	1:1	LCB-JA100	N-CB-41323-2
Drawn by	Code No. :061F 7036		
K. H.			

