

Drawing Number
A002-002

A	HANDWHEEL	Ø A	B	C	Ø d	Ø e	Ø f	G	Ø h	I	J						
A	SG 150-12	150 [5.91]	80 [3.15]	8 [0.34]	12 [0.47]	4 [0.16]	40 [1.57]	16 [0.63]	12 [0.47]	30 [1.18]	40 [1.57]						
	SG 150-15				15 [0.59]	5 [0.20]				42 [1.65]	50 [1.97]						
	SG 200-12	200 [7.87]	80 [3.15]	8 [0.34]	12 [0.47]	4 [0.16]	40 [1.57]	16 [0.63]	12 [0.47]	30 [1.18]	40 [1.57]						
	SG 200-15				15 [0.59]	5 [0.20]				42 [1.65]	50 [1.97]						
	SG 200-20				20 [0.79]	6 [0.24]				50 [1.97]	58 [2.28]	70 [2.76]					
SG 200-25*	25 [0.98]				6 [0.24]	58 [2.28]				70 [2.76]							
B	SG 250-12	250 [9.84]	110 [4.33]	8 [0.34]	12 [0.47]	4 [0.16]	40 [1.57]	20 [0.79]	14 [0.55]	30 [1.18]	40 [1.57]						
	SG 250-15				15 [0.59]	5 [0.20]				42 [1.65]	50 [1.97]						
	SG 250-16				16 [0.63]	5 [0.20]				42 [1.65]	50 [1.97]						
	SG 250-20				20 [0.79]	6 [0.24]				50 [1.97]	58 [2.28]	70 [2.76]					
	SG 250-25*				25 [0.98]	6 [0.24]				58 [2.28]	70 [2.76]						
C	SG 300-12	300 [11.81]	115 [4.53]	8 [0.34]	12 [0.47]	4 [0.16]	40 [1.57]	20 [0.79]	14 [0.55]	30 [1.18]	40 [1.57]						
	SG 300-15				15 [0.59]	5 [0.20]				42 [1.65]	50 [1.97]						
	SG 300-16				16 [0.63]	5 [0.24]				42 [1.65]	50 [1.97]						
	SG 300-20				20 [0.79]	6 [0.24]				50 [1.97]	58 [2.28]	70 [2.76]					
	SG 300-25*				25 [0.98]	6 [0.24]				58 [2.28]	70 [2.76]						
D	SG 350-12*	350 [13.78]	120 [4.72]	8 [0.34]	12 [0.47]	4 [0.16]	40 [1.57]	25 [0.98]	16 [0.63]	30 [1.18]	40 [1.57]						
	SG 350-15*				15 [0.59]	5 [0.20]				42 [1.65]	50 [1.97]						
	SG 350-20*				20 [0.79]	6 [0.24]				50 [1.97]	58 [2.28]	70 [2.76]					
	SG 350-25*				25 [0.98]	6 [0.24]				58 [2.28]	70 [2.76]						
	SG 350-30*				30 [1.18]	8 [0.31]				58 [2.28]	70 [2.76]						
E	SG 400-12	400 [15.75]	130 [5.12]	8 [0.34]	12 [0.47]	4 [0.16]	40 [1.57]	25 [0.98]	16 [0.63]	30 [1.18]	40 [1.57]						
	SG 400-15				15 [0.59]	5 [0.20]				42 [1.65]	50 [1.97]						
	SG 400-16				16 [0.63]	5 [0.24]				42 [1.65]	50 [1.97]						
	SG 400-20				20 [0.79]	6 [0.24]				50 [1.97]	58 [2.28]	70 [2.76]					
	SG 400-25*				25 [0.98]	6 [0.24]				58 [2.28]	70 [2.76]						
F	SG 450-15*	450 [17.71]	150 [5.91]	8 [0.34]	15 [0.59]	5 [0.20]	50 [1.97]	25 [0.98]	16 [0.63]	42 [1.65]	70 [2.76]						
	SG 450-20*				20 [0.79]	6 [0.24]				50 [1.97]	58 [2.28]	70 [2.76]					
	SG 450-25*				25 [0.98]	6 [0.24]				58 [2.28]	70 [2.76]						
	SG 450-30*				30 [1.18]	8 [0.31]				58 [2.28]	70 [2.76]						
	SG 500-15				500 [19.69]	150 [5.91]				8 [0.34]	15 [0.59]	5 [0.20]	50 [1.97]	25 [0.98]	16 [0.63]	42 [1.65]	70 [2.76]
SG 500-20	20 [0.79]	6 [0.24]	50 [1.97]	58 [2.28]			70 [2.76]										
SG 500-25*	25 [0.98]	6 [0.24]	58 [2.28]	70 [2.76]													
SG 500-30*	30 [1.18]	8 [0.31]	58 [2.28]	70 [2.76]													
G	SG 600-20	600 [23.62]	150 [5.91]	10 [0.39]	20 [0.79]	6 [0.24]	50 [1.97]	25 [0.98]	16 [0.63]	58 [2.28]	70 [2.76]						
	SG 600-25*				25 [0.98]	6 [0.24]				58 [2.28]	70 [2.76]						
	SG 600-30*				30 [1.18]	8 [0.31]				58 [2.28]	70 [2.76]						
	SG 700-20				700 [27.56]	150 [5.91]				10 [0.39]	20 [0.79]	6 [0.24]	50 [1.97]	25 [0.98]	16 [0.63]	58 [2.28]	70 [2.76]
	SG 700-25*										25 [0.98]	6 [0.24]				58 [2.28]	70 [2.76]
SG 700-30*	30 [1.18]	8 [0.31]	58 [2.28]	70 [2.76]													
SG 750-20*	750 [29.53]	150 [5.91]	10 [0.39]	20 [0.79]			6 [0.24]	50 [1.97]	25 [0.98]		16 [0.63]	58 [2.28]				70 [2.76]	
SG 750-25*				25 [0.98]	6 [0.24]	58 [2.28]	70 [2.76]										
SG 750-30*				30 [1.18]	8 [0.31]	58 [2.28]	70 [2.76]										
SG 800-20				800 [31.50]	150 [5.91]	10 [0.39]	20 [0.79]			6 [0.24]		50 [1.97]	25 [0.98]	16 [0.63]	58 [2.28]	70 [2.76]	
SG 800-25*	160 [6.30]	25 [0.98]	6 [0.24]		58 [2.28]		70 [2.76]										
SG 800-30*	30 [1.18]	8 [0.31]	58 [2.28]		70 [2.76]												
H	SG 900-20	900 [35.43]	160 [6.30]	10 [0.39]	20 [0.79]	6 [0.24]	50 [1.97]	25 [0.98]	16 [0.63]	58 [2.28]	70 [2.76]						
	SG 900-25*				25 [0.98]	6 [0.24]				58 [2.28]	70 [2.76]						
	SG 900-30*				30 [1.18]	8 [0.31]				58 [2.28]	70 [2.76]						
	SG 1000-20*				1000 [39.37]	160 [6.30]				10 [0.39]	20 [0.79]	6 [0.24]	50 [1.97]	25 [0.98]	16 [0.63]	58 [2.28]	70 [2.76]
	SG 1000-25*										25 [0.98]	6 [0.24]				58 [2.28]	70 [2.76]

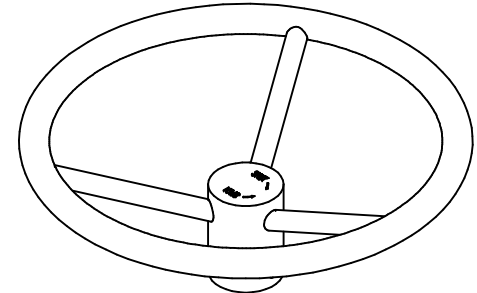
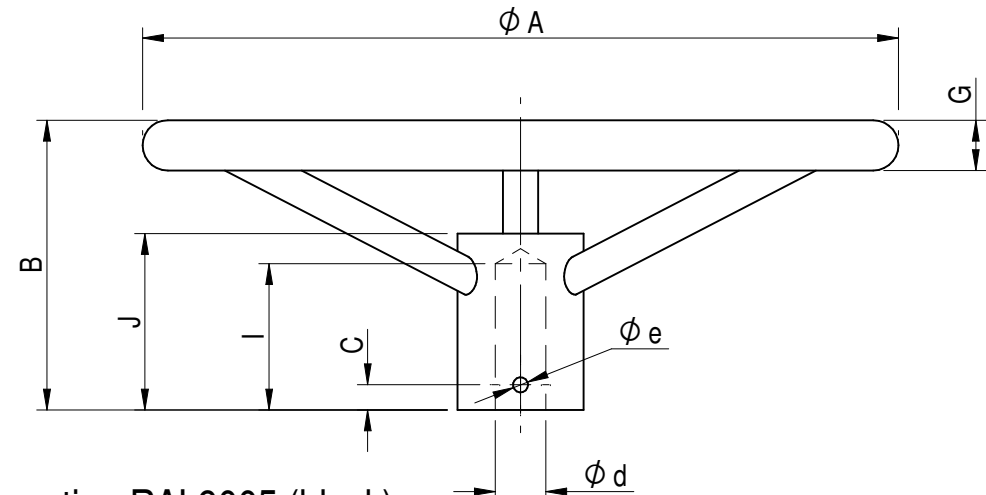
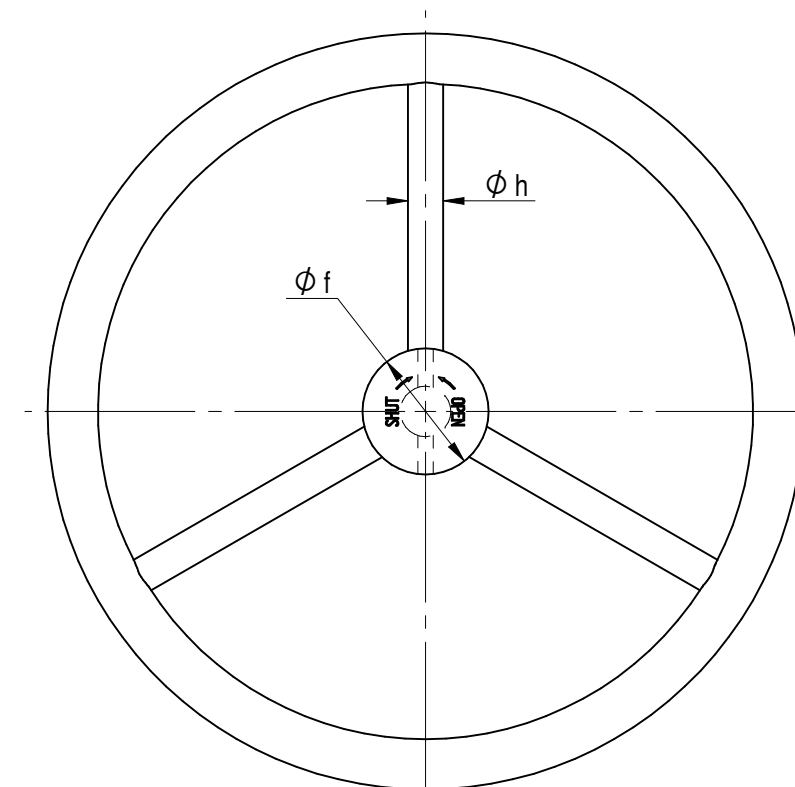

Standard coating RAL9005 (black)
Other colours available on request

SG150 up to SG300 with 3 spokes
SG350 up to SG750 with 4 spokes
SG800 up to SG1000 with 6 spokes

* Only on request

AS PART OF CONTINUOUS PRODUCT DEVELOPMENT, ALL DETAILS SUBJECT TO CHANGE WITHOUT PRIOR NOTICE. FOR UP TO DATE DETAILS PLEASE VISIT www.rotork.com

 LOSSER - THE NETHERLANDS www.rotork.com	This drawing is confidential and is the property of Rotork Gears and must not be reproduced either wholly or partly. All rights in respect of patents, designs and copyrights are reserved. © 2017		Document Type DETAIL DRAWING	Title HANDWHEELS SG-TYPE
	Created Robbin Goosen	10-1-2017	Dimensions in mm [inch]	
	Checked Henk Hoff	10-1-2017	Drawing Number A002-002	Iss. 15
	Approved		Sheet 1 of 1	Size A3