



TIEMME

MINI BALL VALVE "SMALL"

Art. 2900CZ-2940CZ

Mini ball valves PN10 with threaded female/female, male/female or male/male ends UNI ISO 228. Available with or without black plastic handle.

CZ ball valves are manufactured with antidezincificating material CW 602N. This series of products, marked with the international symbol "CR", are recommended for distribution of drinking water with a high content of particular mineral salts. The special alloy CW 602 N, in accordance with the rules EN 12164 and EN 12165, contains some components which maintain the alloy structure intact over the time. The valves suitable for domestic and commercial plumbing, industrial and agricultural applications, heating and sanitary systems, pneumatic systems, oils, generally with every non aggressive fluid.



For the complete range see catalogue

Certifications



VA 1.51/18608



0448/98



VVT-RTH-06184-07



0338

Technical Features

Maximum temperature : 110°C
Minimum temperature : - 20°C(*)
Maximum operating pressure : working limits at 10 bar
Threads : female UNI ISO 228
male UNI ISO 228

(*) provided that the fluid remains in the liquid phase

Description

Material

Treatment

Description	Material	Treatment
Body	CW602N-EN12165 brass	Chrome plated
Ball	CW602N-EN12164 brass	Chrome plated
Stem	CW602N-EN12164 brass	-
Compression ring	CW508L-EN12449 brass	Annealed
Nut	CW617N-EN12165 brass	Chrome plated
O-ring	Nitrile rubber NBR	-
Side washers	Nitrile rubber NBR	-
Handle	PVC	-
Screw	Steel	Zinc plated

Instruction for the correct assembly :

The pipe cut shall be done with appropriate toolings in order to obtain a precise and perpendicular cut without any trimming. The pipe end shall be cleaned in order to remove any remaining trimming. Put nut and ring on the pipe, insert the appropriate pipe support (Art. 1116CZ for soft copper pipe or Art. 1120CZ for Pe-x pipe). Tighten the nut by hand till is possible and then use a key following the instruction of table. To allow a more uniform and plastic strain is suggested to lubricate the compression ring using the appropriate product for the use of the system (potable water,...).

Tabella di serraggio dado / Nut tightness table

Pipe size	10	12	15
N° giri/turns for copper pipe	1,1/4	1,1/4	1,1/4



TIEMME Raccorderie S.p.A.
Via Cavallera 6/A (Loc. Barco) - 25045 Castagnato (Bs) - Italy
Tel +39 030 2142211 R.A. - Fax +39 030 2142206
info@tiemme.com - www.tiemme.com

©TIEMME Raccorderie S.p.A. 2900-2940CZ-scandinavia Rev. A 10-12



TIEMME Raccorderie S.p.A. reserves the right to modify contents in any time without prior advise. Is forbidden any reproduction unless under TIEMME authorization





MINI BALL VALVE "SMALL"

Art. 2900cz-2940cz

Art. 2900 - 2901

Size	1/4"	3/8"	1/2"
Ø (DN)	8	8	10
A	21	21	21
B 2900	29	29	31
B 2930	-	12,5	14,5
CH	21	21	25
E	10	12	10,5
Em	9	10	12
L 2900-2930	39	41,5	46
Lm/f 2901-2931	38,5	39,5	45,5
Lm/m 2902-2932	39	42,5	48
PN	10	10	10

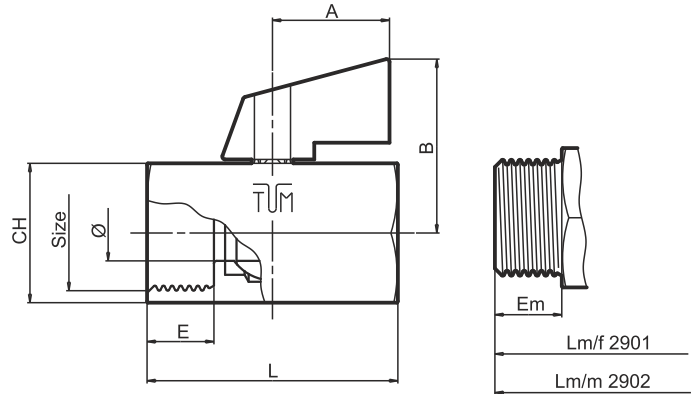

Art. 2940

Size	10x1/2"	12x1/2"	15x1/2"
Ø (DN)	10	10	10
A	21	21	21
B	31	31	31
CH	25	25	25
E	16,5	18,5	21,5
Ef	11	11	11
L	50	51	54,5
PN	10	10	10

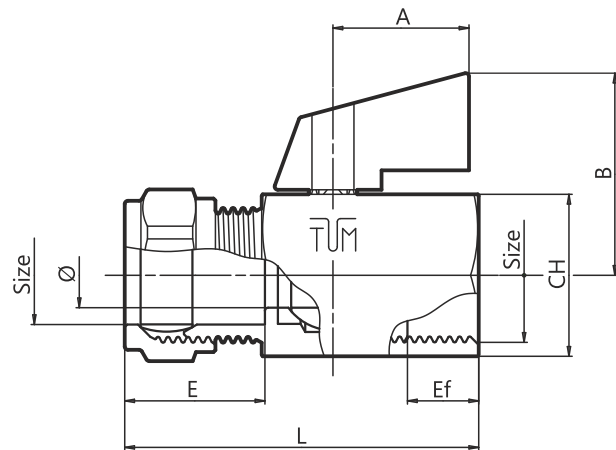

Art. 2942

Size	10X10	10X12	10X15	12X12	12X15	15X15
Ø (DN)	8	8	8	8	10	10
A	21	21	21	21	21	21
B	29	29	31	29	31	31
CH	21	21	25	21	25	25
E	16,5	16,5	16,5	18,5	18,5	21,5
L	57	57,5	62	58,5	62,5	66,5
PN	10	10	10	10	10	10

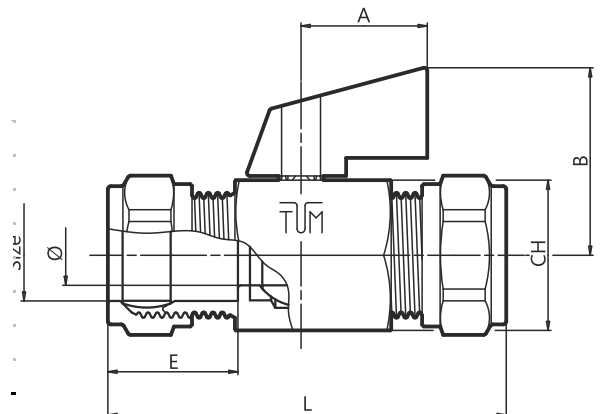

TIEMME Raccorderie S.p.A. reserves the right to modify contents in any time without prior advise. Is forbidden any reproduction unless under TIEMME authorization





MINI BALL VALVE "SMALL"

Art. 2900cz-2940cz

Pressure / temperature diagram

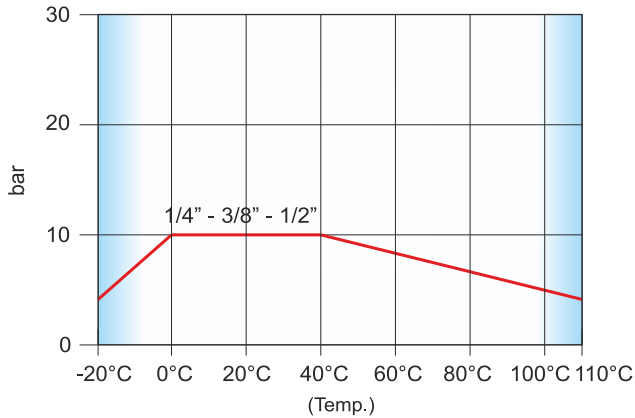

Flow/pressure drop diagram

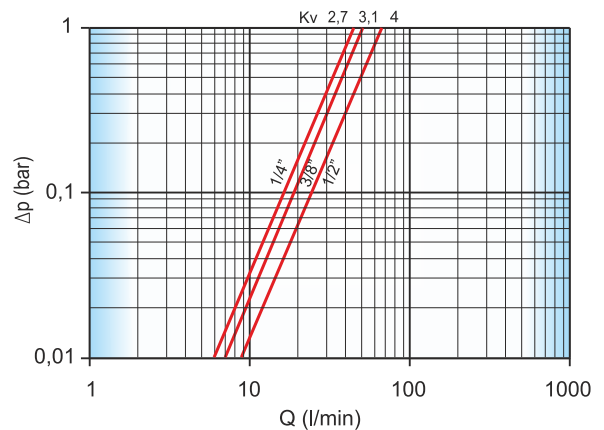

Installation instructions

The valves can be installed in any position (horizontal, vertical, ...) provided that shall be placed in visible and accessible position and the open/close operations shall be easily and completely done.

Otherwise stated to close the valve the handle shall be turned clockwise, counterclockwise to open it.

Otherwise stated by specific marks on the valve body (arrows,...) there is no valve flow direction.

The system shall be designed and realised in order to avoid any stress that could damage the valve and could compromise the sealing and the correct working of the valve.

All installation operations shall be done using properly tooling. The tightenings shall be such as to guarantee the sealing but without make any damage to the valve or fittings.

Once the installation have been completed is necessary to verify the sealings according to technical specifications and/or what required by the country of installation.

The valve should not be kept in intermediate position for a long period of time in order to avoid any damages of the valve sealings.

If the valve have not been used for a long period of time it may be difficult to operate therefore it will be necessary to use a "long lever".

To kept the valve and sealings in good conditions it is suggested to place a filter upstream in order to stop impurity.

Tiemme Raccorderie SpA decline any responsibility in case of damages and/or accidents when the installation is not done in conformity with technical and scientific rules in force and in conformity with manuals, catalogues and/or technical documentation written by Tiemme Raccorderie SpA.

For any further information please refer to your local dealer or directly to TIEMME S.p.A.