

## Product information

Low neck, full flow, internal thread, and steel handle. Viridi ball valve in dezincification-resistant lead-free brass (less than 0.1% lead). For hot and cold water, as well as heating, cooling, air, and gas systems. Can also be used for vacuum and lighter oils (such as diesel).

Dimension range (DN)	10 - 50
PN	25 - 40
Temperature (°C)	0 - 150
Main material	Brass



## Area of use

Viridi shut-off valve for hot and cold tap water, as well as heating, cooling, air, and gas systems. It can also be used for vacuum and lighter oils (such as diesel), see also section "Installation".

For tap water, refrigeration and heating systems (fluid group 2), the range is -30°C to +130°C. For flammable liquids, maximum 16 bar. PN40 for ≤DN50 (Max 40bar empty +95°C, max 25bar at +150°C)

PN25 for ≥DN65 (Max 25bar empty +95°C, max 16bar at +150°C)

Suitable for water from 0°C to 150°C.

Suitable for air from -10°C to 150°C.

Can be used down to -30°C in cooling systems with glycol-blended media.

## Tender text

### PSB.1 Ball valves

Green ball valve in dezincification-resistant lead-free brass (lead content below 0.1%) AT 3700, G... With full flow, internal thread, and steel handle. Packing made of graphite and a Teflon-coated ball. The Viridi ball valve AT 3700 is approved for installation where requirements from the Building Assessment and Healthy House have been set.

## Quality assurance

PED 2014/68/EU art 4.3, AFS 2016:1, 8 paragraf

The Viridivent valves may be used for liquids and gases in group 2 according to AFS 2016:1. The Viridivent valves are covered by AFS 2016:1, section 8, the directive for pressure equipment (PED 4.3) and therefore may not be CE marked. The Viridi range is made of alloys that are covered by the "4MS Common Composition List" which includes materials and products approved for use in contact with drinking water.

**Product marking:** Brand, PN and DN.

## Energy and environment declaration

**Product Bvb:** Accepted

**Product BVB ID:** 115518

**SundaHus:** C-

Pos	Component	Material
-----	-----------	----------

## Measurements and weight

**Dimension range (DN):** 10 - 50

DN	10	15	20	25	32	40	50
A	39	49	58	67	81	94	110
B	9	11.5	12	14.5	16	17	19
C	41	53	57	65	71	79	87
E	81	91.5	91.5	126.5	126.5	141.5	141.5

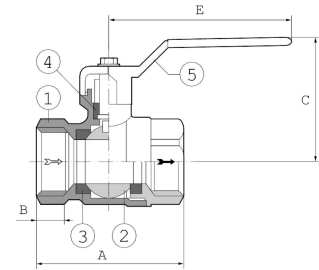

## Function and design

The AT 3700 has a fully threaded and adjustable graphite box. The AT 3700 also features a "blow out-safe" spindle. The DN40 and DN50 ball valves can be equipped with slow-closing handles, such as the 3700V40 and 3701V50.

## Technical data

**Main material:** Brass

**Main material code:** Brass (CuZn38As) (CW511L, Pb<0,1%)

**Included materials:** Brass, Stainless steel, Steel, Other

**Included material code:** Brass (CuZn38As) (CW511L, Pb<0,1%), PTFE (polytetrafluoroethylene)

**Temperature (°C):** 0 - 150

**Temperature notes:** PN40 for ≤DN50 (Max 40bar at +95°C, max 25bar at +150°C) PN25 for ≥DN65 (Max 25bar at +95°C, max 16bar at +150°C) Used for water from 0°C to 150°C. Used for air from -10°C to 150°C. Can be used down to -30°C in cooling systems with glycol-containing media.

**PN:** 25 - 40

**Connection:** Internal thread ISO 228-1 (G, BSPP)

**ETIM classification:** EC011343 - Ball valve

**BK04 code:** 20702 Ball valves

**BIM link:** <https://redir.magicad.cloud/product/b015e329-f245-4abf-ab06-5d04002568ed>

**Comment to colour:** Natural colour, untreated.

DN	Net weight (kg)	KVS
10	0.22	5.8
15	0.22	15.7
20	0.308	30.8
25	0.526	49.3

DN	Net weight (kg)	KVS
32	0.809	79
40	1.198	125.3
50	1.8	224.2

## Installation and maintenance

**Flowdirection:** Bi-directional

**Possible mounting position:** Vertical, Horizontal

"All valves have internal pipe threads. Tightening of the packing may be necessary for air and gas systems when the test pressure exceeds 6 bar. The valve should be operated regularly to avoid accumulation of dirt that can lead to leakage."

Please feel free to contact us

We answer your questions by e-mail and telephone. No question is too small, no challenge is too big. You are always welcome at Armatec.

post@armatec.no | +47 23 24 55 00 | www.armatec.no

THE COMPANY'S MANAGEMENT SYSTEM  
IS CERTIFIED BY KIWA  
ISO 9001 • ISO 14001