



## Product information

Fully welded pipe construction with welded end and internal thread. The passage of the ball is restricted by one dimension. Shut-off valve for hot and cold water systems, as well as compressed air and gases. The ball is clamped between two seat rings made of carbon-filled PTFE. All dimensions are equipped with ISO top.

Dimension range (DN)	10 - 50
PN	40
Temperature (°C)	-20 - 200
Main material	Steel



## Area of use

Shut-off valve for hot and cold water systems as well as compressed air and gases.

## Tender text

### **PSB.1 Ball valves**

Ball valve AT 3591S with lever, DN ... Housing made of steel with one welded end and one internal threaded connection. With spindle neck adapted for over-insulation. ISO top according to 5211.

## Quality assurance

PED 2014/68/EU, AFS 2016:1

**Product marking:** DN, PS, material in load-bearing parts, manufacturing year and month, and AT number are indicated on the valve's nameplate.

## Energy and environment declaration

**SundaHus:** C-

Pos	Component	Material
-----	-----------	----------

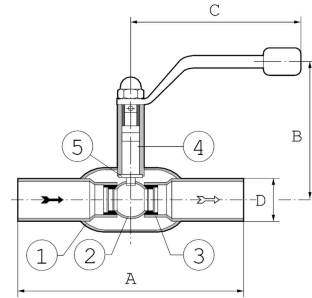

## Measurements and weight

**Dimension range (DN):** 10 - 50

## Function and design

Fully welded pipe construction with welded ends, suitable for direct welding into pipe systems. The passage through the ball is restricted by one dimension. The ball is clamped between two PTFE seat rings. The valve is supplied as standard with an ISO top and a high spindle neck for over-insulation. The upper part of the spindle is always visible and inspectable. The valve has a re-tightenable packing box.

## Technical data

**Main material:** Steel

**Main material code:** Steel P235GH (1.0345)

**Included materials:** Steel, Other

**Included material code:** Steel P235GH (1.0345), PTFE (polytetrafluoroethylene)

**Temperature (°C):** -20 - 200

**PN:** 40

**Connection:** ISO 1127, weld end, Internal thread ISO 228-1 (G, BSPP)

**ETIM classification:** EC011343 - Ball valve

**BK04 code:** 20702 Ball valves

**MagiCAD link:** <https://redir.magicad.cloud/product/0d6e07fa-fd8d-45ec-b421-d102b9826d14>

## Installation and maintenance

**Flowdirection:** Bi-directional

**Possible mounting position:** Vertical, Horizontal

The valve can be installed in any position, regardless of the direction of the flow of the medium. Welding should be done with the ball in the fully open position. When gas welding, it is especially important to cool the valve housing at the same time so that the seat rings are not damaged. The valve should be operated regularly to avoid the accumulation of dirt that can lead to leakage.

Please feel free to contact us

We answer your questions by e-mail and telephone. No question is too small, no challenge is too big. You are always welcome at Armatec.

[info@armatec.se](mailto:info@armatec.se) | +46 31 89 01 00 | [www.armatec.se](http://www.armatec.se)

THE COMPANY'S MANAGEMENT SYSTEM  
IS CERTIFIED BY DNV  
ISO 9001 • ISO 14001